

RD

RallyDash

TRIPMASTER 5



INSTALLATION INSTRUCTIONS

Mount your RallyDash 5 Tripmaster on your instrument panel using two M6 bolts or studs. Rubbers bushings are advised to dampen vibrations.

Two holes and one larger hole are needed to mount the RallyDash 5 Tripmaster and feed the connection cables through your instrument panel. We use 12mm rubber dampers to support the unit on a bike, 7mm is enough when mounting the unit inside a vehicle.

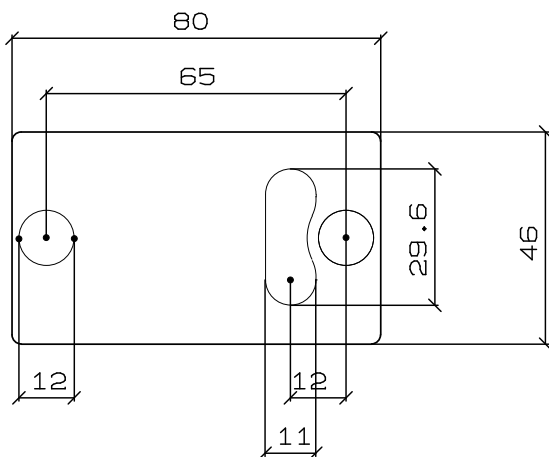

RallyDash 5 Tripmaster has three connection cables: power (red), remote control (blue), sensor (yellow). It can be used stand alone or together with a Powerbox, which can power several RallyDash 5 Tripmasters and is a requirement for the optional RallyDash GPS mouse.

Power (red): RallyDash 5 Tripmaster requires a power source of 9-15VDC to function and charge the internal battery. The power cable is included in the kit or can be ordered separately. Connect it to your vehicles 12v system using a fuse. Black is +, Blue is -, Brown is used for the 'Power User' GPS function and can be left untouched in most situations.

Remote control (blue): Connect the remote control unit and the optional foot pedal to the blue connector. The remote control can be mounted on handlebars but also directly onto the instrument panel.

Sensor (yellow): RallyDash provides perhaps the most sturdy sensor cable available. On a bike, the sensor and magnet can be mounted on the front wheel near one of the holes of the brake disc. Make sure the cable can run freely independent of steering and suspension travel, and is guarded from debris, branches etc.

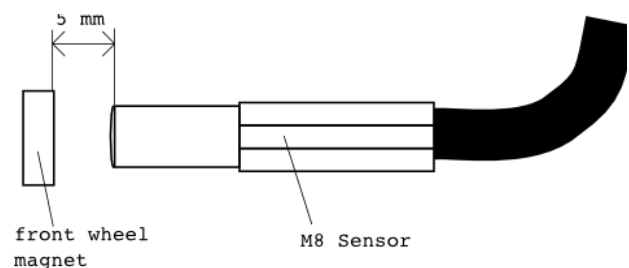

Optional RallyDash GPS Mouse (red): The RallyDash GPS Mouse can be the main source for the RallyDash 5 Tripmaster, or used in connection with the sensor. The GPS Mouse is connected to the Powerbox, from which its signal can be used by multiple RallyDash 5 Tripmasters. The RallyDash GPS Mouse needs a clear view of the sky to function.

Optional 'Power User' GPS: For 'power users' there is an unsupported option to connect a NMEA2000 GPS device to the brown wire in the power cable. This allows you to use the RallyDash 5 Tripmaster as a stand alone unit, or gives you a backup GPS signal. As we cannot troubleshoot NMEA2000 devices, we do not offer support for this option.

➔ POWERMANAGEMENT

RallyDash 5 Tripmaster will run from its internal battery when the external power is lost. The internal battery is charged when the external power is connected again. After approximately 2 hours the internal battery will be fully charged.

If no inputs are received from the sensor, the remote control buttons or the GPS mouse, the RallyDash 5 Tripmaster will go to sleep mode and switch off the display to save power. When an input is received the RallyDash 5 Tripmaster will wake up again.

The optional Powerbox allows several RallyDash 5 Tripmasters to share one power supply and one GPS source, such as the RallyDash GPS Mouse. The female power cable connects the Powerbox to the external power source.

➔ SENSOR AND GPS

RallyDash 5 Tripmaster uses the sensor as default, but it can function perfectly reliable with only the GPS as input. For ease of use and reliability we offer the optional RallyDash GPS Mouse and Powerbox.

When using the RallyDash 5 Tripmaster with both sensor and GPS input, the sensor will be the default source for distance. CAP will be used from the GPS. If there is no input from the sensor, after approx. 100m the RallyDash 5 Tripmaster will switch to the GPS as input source. If you use the RallyDash 5 Tripmaster without sensor, the first 100m distance will not be shown after it has been switched on

➔ CONFIGURATION

Using the buttons on the remote you can configure and operate the RallyDash 5 Tripmaster. On the remote control there is one [mode] button and two buttons for the [+] and [-], which can be used to scroll through menus and adjust values.



Switch on the power to your RallyDash 5 Tripmaster. The display shows the menu options at the bottom:

```

\TRIP/ STAGE SPEED COG TIME
  
```

Use the + and - button on your remote control to scroll to the 'SETUP' menu option:

```

WHEEL      : 218 CM  ▲●
GPS/ROAD   : 0.0 %
TIME       : 13:43  [ ]
STAGE SPEED COG TIME \SETUP/
  
```

Push the Mode button to go into the setup menu:

```

WHEEL      : 218 CM  ▲●
GPS/ROAD   : 0.0 %
TIME       : 13:43  [ ]
LIGHT      : 6
  
```

Use the + and - button to do the settings. The Mode button will bring you to the next item.

Turn your wheel to test the sensor connection to your RallyDash 5 Tripmaster. The sensor indicator should blink every time the magnet in your wheel passes the sensor. When a GPS device is connected to RallyDash 5 Tripmaster the GPS indicator will blink every time that GPS information is received.

➤ SETUP MENU ITEMS EXPLAINED

→ Wheel

This is the wheel circumference used to calculate the distance traveled. During driving you can change this number to compensate for variations in the roadbook distances.

→ GPS/road

During driving it is possible to 'manipulate' the real distance measured by the GPS to compensate for variations in the roadbook distances.

→ Time

Set the clock of the RallyDash 5 Tripmaster.

→ Light

Change the back light setting of the display. For sunlight conditions set the backlight to the maximum of 10, for low light conditions and during night time you can dim the backlight.

→ Distance display mode

RallyDash 5 Tripmaster has two distance display modes: 10m and 100m. Adjust to suit the roadbook you are using.

When finished setting up, go back to the main menu and scroll through the menu options using the + and - button on your remote control.

➔ OPERATING THE RALLYDASH 5 TRIPMASTER

After installation and configuration you can now start using your new tripmaster.

➤ START A NEW TRIP

Go to the trip or stage mode and hold the Mode button till the following message appears:

rally-dash.com v4.2
Start?
Yes

Hold the Mode button to reset your RD to 0.

➤ TRIP MODE

TRIP mode: 123.4
123.4

Use the trip mode to show the total distance driven. Push the upper and lower button of your remote control to adjust the total distance traveled and match it with your road book.

➤ STAGE MODE

STAGE mode: 2 12.3
2 12.3

Use the stage mode to zero the distance with each tulip or situation from your road book. Push the + or - button on your remote control to increase or decrease the stage number.

➤ SPEED MODE

SPEED mode: 145 81 89 KPH
145 81 89 KPH

Use the speed mode to monitor your speed. Also the average speed and maximum speed since the start of your trip are shown here.

➤ COG MODE

(only works when a GPS device is connected)

COG mode: (only works when a GPS device is connected) 214 °
214 °

Use the COG mode to display the true heading in degrees, the 'Cap Over Ground'. With this functionality there is no need for a separate CAP (Course) repeater.

➤ TIME MODE

TIME mode: 12:34
12:34

Use the time mode to keep a 'rally time' on your steering wheel while rallying through multiple time zones and make sure you are in time at the start of a new trip.

You can switch between all modes while driving. For example if you want to calibrate your wheel circumference to better match the road book, you can do this while driving.



Correspondence Address
Garderbroekerweg 209,
3774 JE Kootwijkerbroek

visiting address
Aalsvoort 51a,
7241 MA Lochem
(by appointment only)

Tel (+31) 655 392 335 *

Email info@rallydash.nl **

* Available on workdays
from 9 a.m. to 6 p.m.
** Response by email
usually within 1 day.

KvK 76465772

Bank
Rabobank
NL76 RABO 0347979300

BTW
NL86 0632866 B01